

HARPERS VALLEY RESORT

Lake front in the heart of Table Rock Lake
Kimberling City, MO 65686

800-688-2193

relax@harpervalley.com

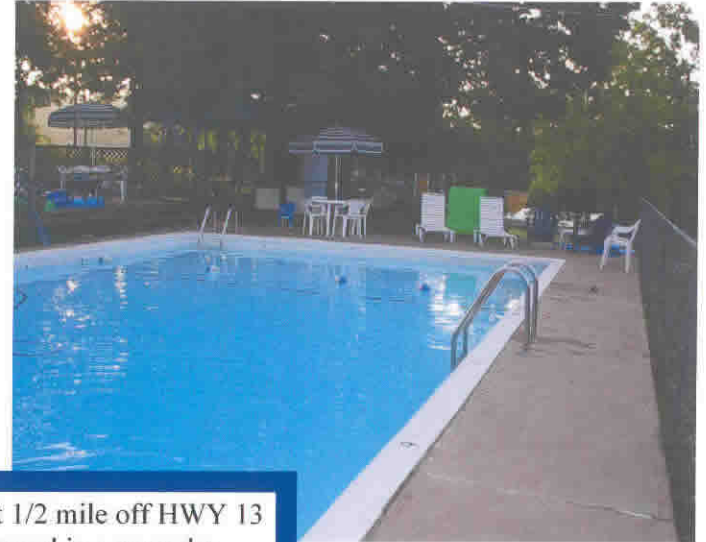

Come enjoy the lake with us. Just 1/2 mile off HWY 13 in a quiet cove with no road traffic and in a no wake zone. We offer great affordable fun for everyone. From our efficiency unit to our deluxe 2 bedroom.

Harpers Valley Resort is just 8 miles to Silver Dollar City and 13 miles from Branson. We offer boat rental, slip rental, concrete boat launch, play area for the kids, pavilion for group BBQ cook outs. A 22x44 foot built in pool, fire pit for late night fun, **laundry facility on site and wireless internet.**

Let us make your next vacation a memorable one!



FUN YARD GAMES



Great fun, relaxing atmosphere, sparkling clean units all in a park like setting.

Come stay for a few days or stay for the week.

SORRY NO PETS ALLOWED

**CALL TODAY TO MAKE YOUR
RESERVATION
800-688-2193**



Harpers' Valley Resort

12 South St. ~ Kimberling City, MO 65686

417-739-2789 ~ 800-688-2193

harpervalleyresort@hotmail.com ~ relax@harpervalley.com

www.harpervalley.com

Your Host: Basil and Nancy Ellis

OPEN ALL YEAR!

Harpers' Valley Resort is located lake front in a quiet cove called Fisher Creek on Table Rock Lake. Only 1/2 mile off HWY 13 on all paved roads. Just minutes away is the Kimberling City Shopping Center, post office, churches, restaurants and area story telling theater. We are only 7 miles from Silver Dollar City and 13 miles from all the shopping and music shows of Branson.

Our area at a closer look has jet ski rental with delivery and pick-up, free tennis and basketball courts and horse back riding just minutes away. For the golfer we are located 1/2 mile away from a public course and just 7 miles from Stonebridge, one of the top 10 golf courses in Missouri. Just down our cove are 2 restaurants you can dock up to and run in for a bite to eat and with a full service marina just around the corner you'll have everything you need.

We are on a quiet dead end with no traffic past our resort by car or boat. Our facilities include a 22'x44' pool with pool side deck with tables, chairs, lounge chairs, pavilion with tables, ice, Grill and shaded patio for relaxing.

For the kids we have a park like setting with plenty of room to run and play, ride bikes and play area.

For the boater we have boat launch, covered and lighted dock with ele. hook-up or ele. outside units.

New Fire Pit for late night fun and hammock for a relaxing afternoon siesta.

RATES and DATES 2008

SUMMER and HOLIDAYS
June 14 - Aug 115 May 23 - 25 ~ Aug 29, 30, 31

2 Bedroom Units 1,2,4,5 & 6\$95.00 a night for first 4.

2 Bedroom Deluxe Units 3,7 & 8..\$104.00 a night for first 4.

Efficiency Units 9,10,11,12.....\$64.00 a night up to 4.

OFF SEASON

Jan. 1 - June 13 Aug. 16 - Dec. 31

2 Bedroom Units 1,2,4,5 & 6.....\$64.00 a night for first 4.

2 Bedroom Deluxe Units 3,7 & 8..\$69.00 a night for first 4.

Efficiency Units 9,10,11,12.....\$44.00 a night up to 4.

Extra person rate is \$7.00 per day per person

Reservation/Deposits/Refunds

A deposit is required for all reservations. Late arrivals and early departures will be charged for all days reserved. Since all of our business depends on reservations, we have a 21 day cancelation for a full refund. Anything less than 21 days we will refund your deposit after we fill your reservation.

Balance due on arrival with cash, personal check, travelers check, Master Card, or Visa.

Deposit must be made by check or money order.

Groups of 3 or more cabins must be paid 30 before arrival date.

Check-In/Check-Out

Check-in times is after 3 p.m. to 10 p.m.. If you will not be arriving during these hours please let us know. We can arrange to leave a key in your unit.

Extra Persons

Units rated for 4 people. Each additional person will be charged \$7.00 per day.

SORRY, NO PETS ALLOWED

Facilities & Accommodations

Units 1- 8 all have AC/Heat, ceiling fans with new carpet throughout,color TV/DVD player, full kitchens with full size stove/oven and frig, coffee maker/filters, toaster, microwave, cookware dishes, flatware, dish soap, kitchen and bath towels, linens, bath and hand soaps, toilet paper and trash bags. Each unit has a grill and deck with chairs.

Deluxe Units #3, #7 and #8 have 27" TV/DVD player in living room and 19' TV in master bedroom, blender, crock pot and iron and ironing boards.

Units 9 - 12 all have AC/Heat, ceiling fan, new carpet, kitchenette with small frig, coffee maker/filters, microwave, toaster, flatware, dishes, dish soap, kitchen and bath soaps and towels, linens, toilet paper and trash bags. Each unit has a small patio overlooking the lake with grill and deck chairs.

Please provide your own pool/lake towel

Rentals

Boat Slip Fee.....\$7.00 per day
20ft. Pontoon\$150.00/full day
.....\$90.00/4 hours
.....\$700.00 weekly

Gas and oil extra on boat rental.

**CALL 800-688-2193 TODAY
TO MAKE YOUR RESERVATIONS**

Harpers' Valley Resort

A park like setting that is lake front on Table Rock Lake
A great place for family vacations, fisherman, reunions and group or couples retreat

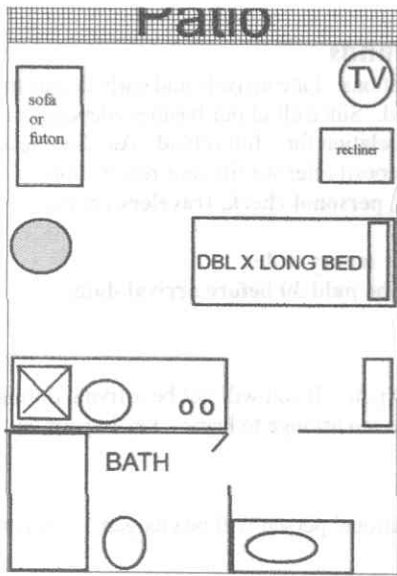

Efficiency Units 9, 10,
11 & 12

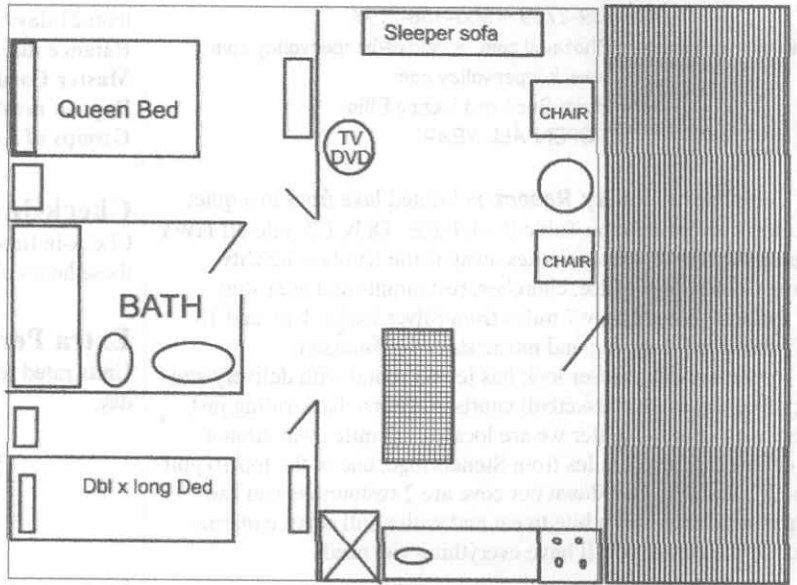

2 Bedroom Kitchen Units 1&2
Sleeps up to 6 people

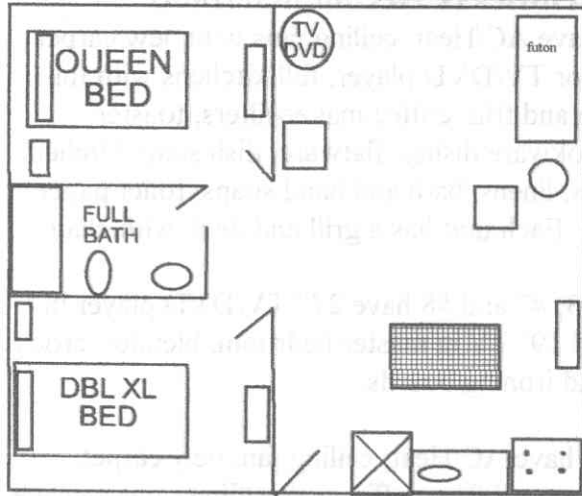

2 Bedroom Kitchen Units 4,5,6 Sleeps up to 6.

Deluxe 2 Bedroom Kitchen Unit 3,7 & 8 - Sleeps up to 7
people- see to the right.

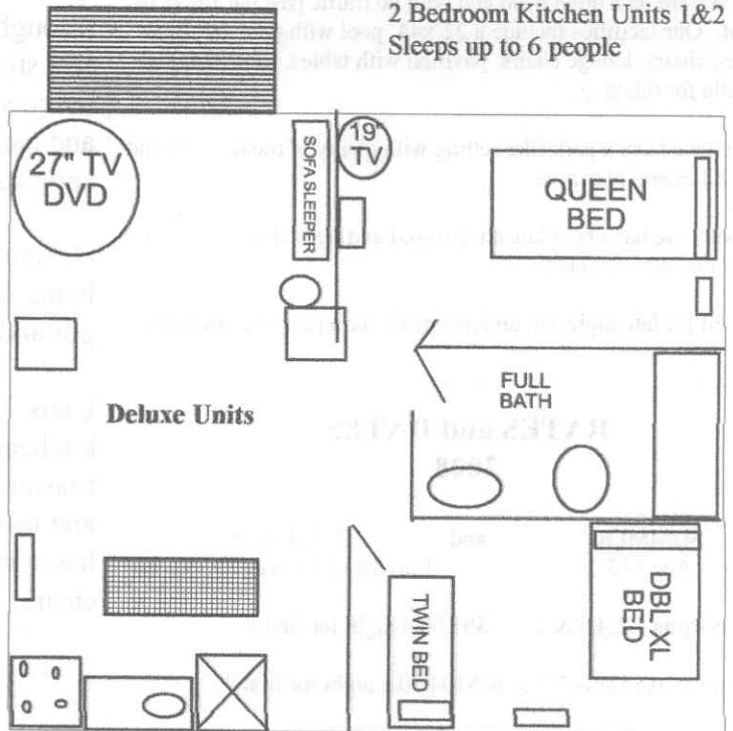

Summer Rates

Efficiency Units 9-12 - \$64.00 a night.

All 2 Bedroom Kitchen Units have DVD players.

Units 1,2,4,5 & 7 - \$95.00 a night

Deluxe 2 Bedroom Kitchen Units have 27" TV w/DVD player in living room and 19" TV in master bedroom.

Unit 3,7 & 8 - \$104.00 a night.

All rates based on first 4 people.

Each additional person \$7.00 a day

Boat slips are \$7.00 a day.

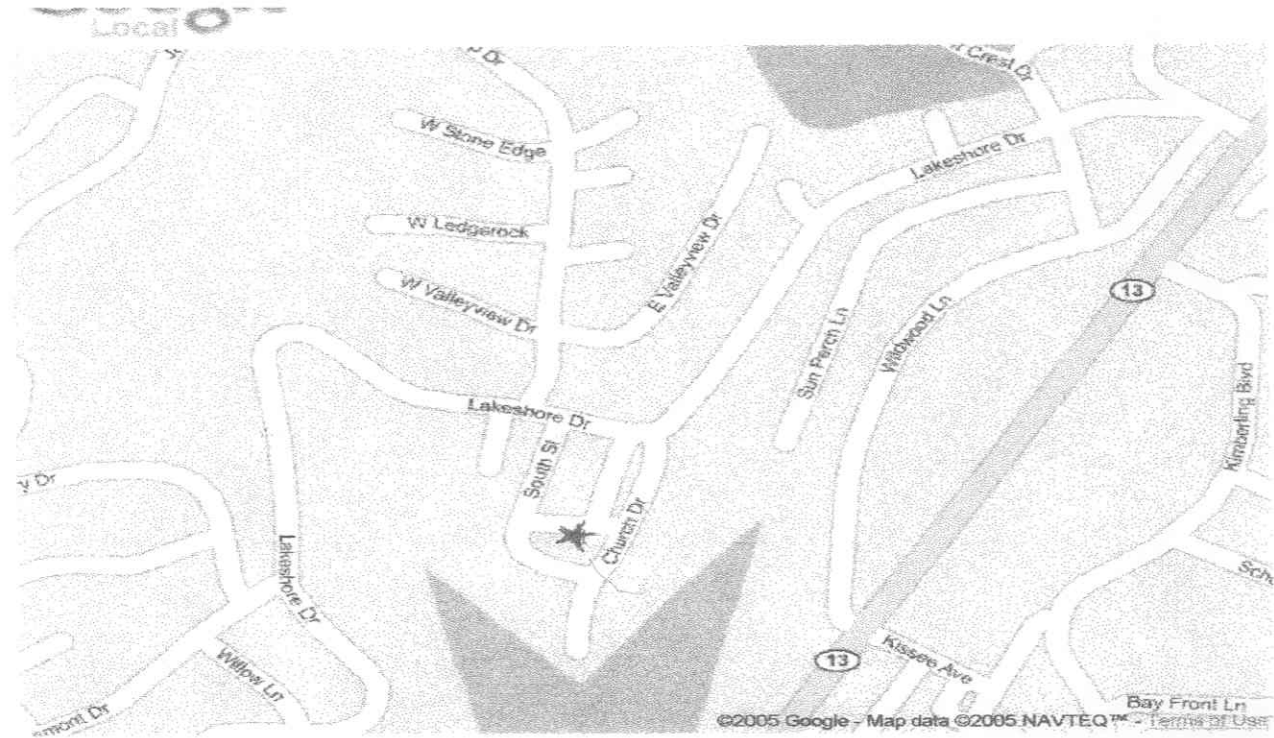

Take 13 South. Turn right on to Lakeshore Dr. Follow 1/2 mile. Take a left on to Church Dr.. (If you are pulling a boat it will be easier to turn left on to South St..)

HARPERS' VALLEY RESORT

Lakefront on beautiful Table Rock Lake
12 South St. Kimberling City, MO 65686
www.harpervalley.com



If your looking for a family vacation or a family reunion we have the spot for you. Located lakefront in a park like setting your sure to love Harpers Valley caters to the families and reunions.

If your group is big enough we will have a breakfast cook out for your group on us!

We have had everything from Weddings, Business Meetings to Church Events at Harpers' Valley Resort.



Our facilities have accommodations that sleep from 2 to 8 people per cabin.

We have 3 Deluxe units that have 27" TV with DVD players in living room and 19" TV in Master Bedroom. These sleep up to 8 people.

Our spacious 2 bedroom unit that we have 5 of, sleeps up to 6 people and have 19" TV with DVD player in living room.

We also have 4 basic efficiency units that sleep up to 4 people and are all lake front with patio view with no steps.



We are located in Fisher Creek on the North West side of Kimberling City. Just 1/2 mile off HWY 13 on all paved roads.

For the boaters we have boat launch with new concrete ramp in 2006. Also covered and lighted boat dock with ele. hook-up slips.

Our cabins are only 70 yards from waters edge with a gentle slope in a park like setting. We also offer ele. hook-up outside of cabins for the spring and fall boater that would prefer to not put your boat in the water.

Call for our great spring and fall packages and rates.

We also offer great deals for clubs that would like to hold tournaments on our lake with a great cook out on us.

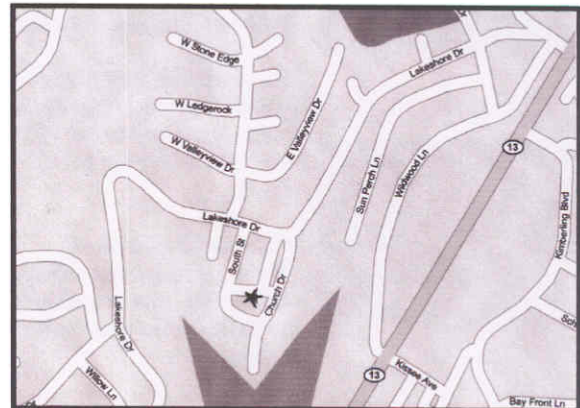

OPEN ALL YEAR ~ 800-688-2193